

# The Pencil Line

**Volume 2**   Rebecca Swindell And Contributing Artists

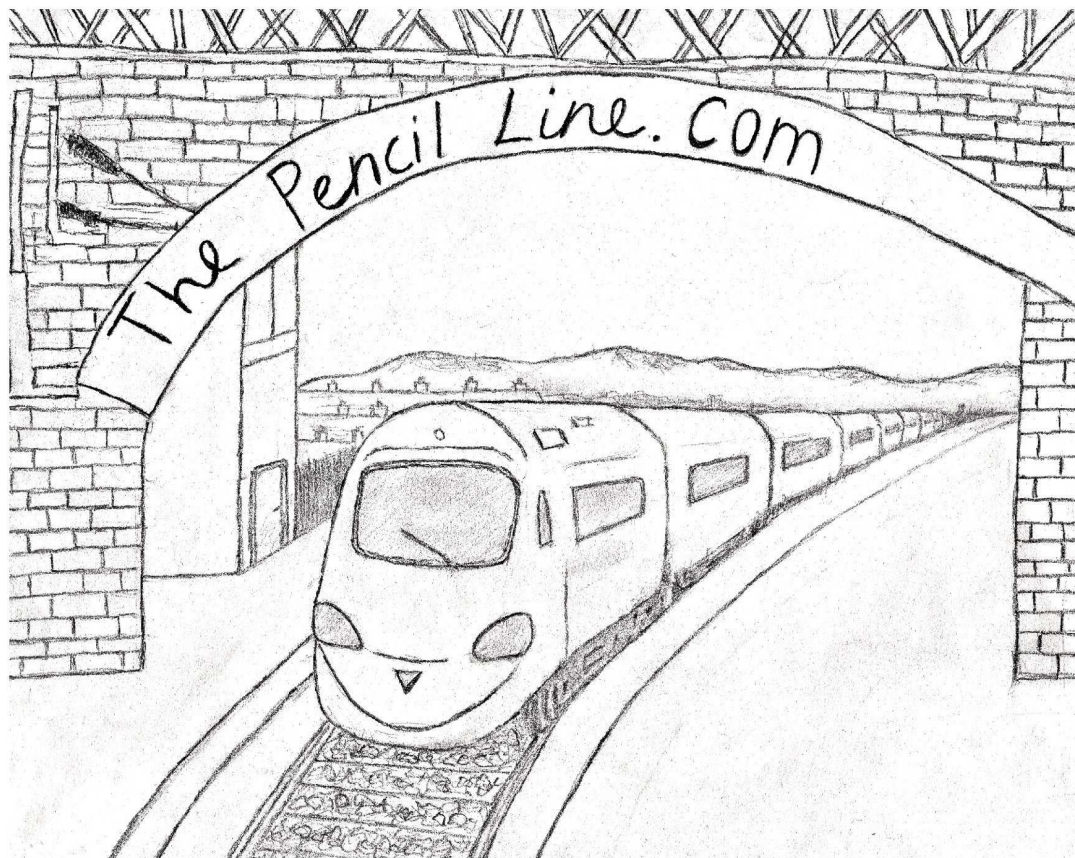



# **The Pencil Line**

## **Volume 2**

Selected And Edited By Rebecca Swindell

© 2012 by the author of this book. The book author retains sole copyright to his or her contributions to this book.

The Blurb-provided layout designs and graphic elements are copyright Blurb Inc., 2012. This book was created using the Blurb creative publishing service. The book author retains sole copyright to his or her contributions to this book.



## **The Pencil Line**

The Pencil Line project began in September 2014 and was set up by artist Rebecca Swindell in partnership with Virgin West Coast Trains LTD. The project, which will run until October 2015, creates an online gallery of drawings produced by people travelling on trains.

A number of the drawings submitted have been selected for volume 2 of the project's ebook editions. They are available through our website [ThePencilLine.com](http://ThePencilLine.com) in PDF and ebooks editions.

The book aims to highlight individual drawings and tell you a little more about the artists who contributed and their inspiration.

The project also involves a series of drawing workshops to be held on the train line for community artist groups. These responses can be found in the artist group section.

With special thanks to Virgin West Coast Trains LTD and all their wonderful staff particularly Helen Reid, Sue Howarth, Harry Dunning and Sharon South who have made this project possible for us all.

The artists Deborah Aguirre Jones, Val Drayton and Georgina Huntley. Project mentor Clare Thornton and website designer Dane Watkins eatmydata and to the artist group who visited Bradford on Avon.

And to all those who have contributed, Many Thanks!

## Contributing Artists

Anonymous - View	Page 9
Isabella P- Dreams of the Highlands	Page 11
Maria - Preston skies look like Russian Skies	Page 13
Mr Matthew – Patterns on The Train	Page 15
Eve - Train	Page 17
Anonymous- - Lee and Caitlin	Page 19
Jean Akin -Traveling Home with An Inherited fairy	Page 21
Mela - Voice Of The Voiceless (check)	Page 23
Arthur Marriot - The Fourth Rail Bridge	Page 25
Douglas and Betsie - First Class Dirty Weekend	Page 27
Sarah Edward and Logan Ewan	Page 29

Fatema Mansoori – Post exam get away	Page 31
Levi Taylor - Butterflies and Flowers	Page 33
Miriam -Tunnel View	Page 35
Chelsea Taylor - Angels	Page 37
Tommy Clark – My Friday Commute	Page 39
Georgina Plowder - Terrible Tommy	Page 41
Philip Adams - Snap Shots Of A Journey	Page 43
Anonymous	Page 45
Quentin Lee - Fuzi Temple In Nanjing	Page 47
John Kirk - Bike Ride for Breast Cancer	Page 49

Dr Ashley Sibery - Wave (Mechanics) To Sheep	Page 51
Bea Mills - Pencil Platform	Page 53
Anonymous - Wonderful Journey Of Imagination	Page 55
Artist Group - Martin Davis	Page 59
Artist Group - Kris smith	Page 61
Artist Group - Ashley Valentine Goudou	Page 63
Artist Group - Jayne Porter	Page 65
Artist Group - Cythia Booth	Page 67
Morgan Cameron - Project Ability Artist	Page 69
Rebecca Swindell - Artist in Residence	Page 73

**Anonymous - View**



## **Isabella P - Dreams Of The Highlands**



## **Maria - Preston Skies Look Like Russian Skies**



## **Mr Matthew – Patterns On The Train**

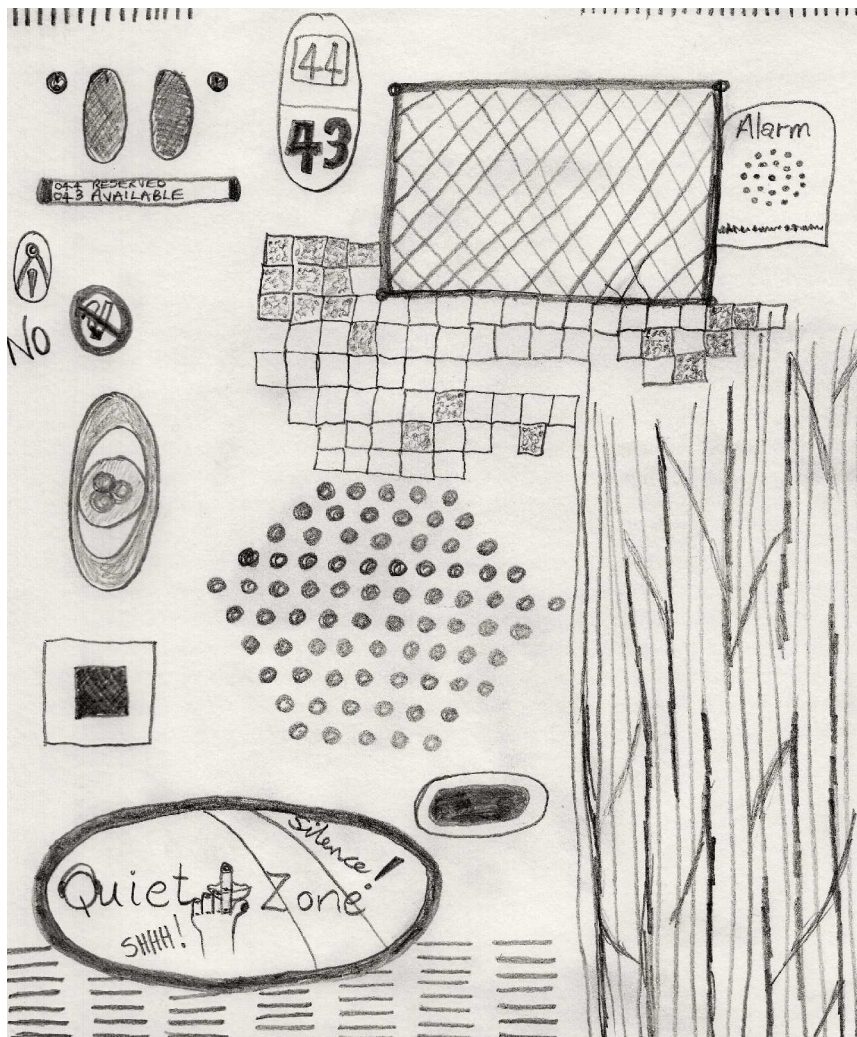

**Eve - Train**

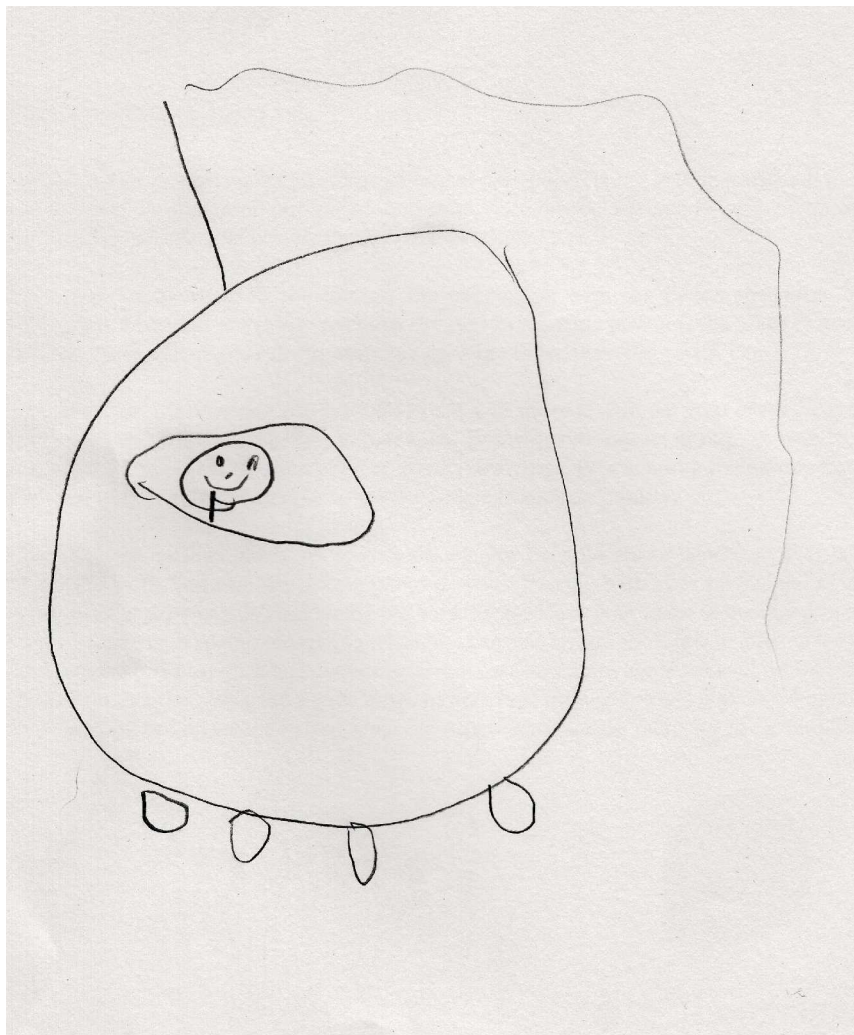

**Anonymous - Lee and Caitlin**



**Jean Atkin - Traveling Home With An Inherited Fairy  
Poet & Writer in Education & Community.**

**[www.jeanatkin.com](http://www.jeanatkin.com)**



## **Mela - Voice Of The Voiceless**

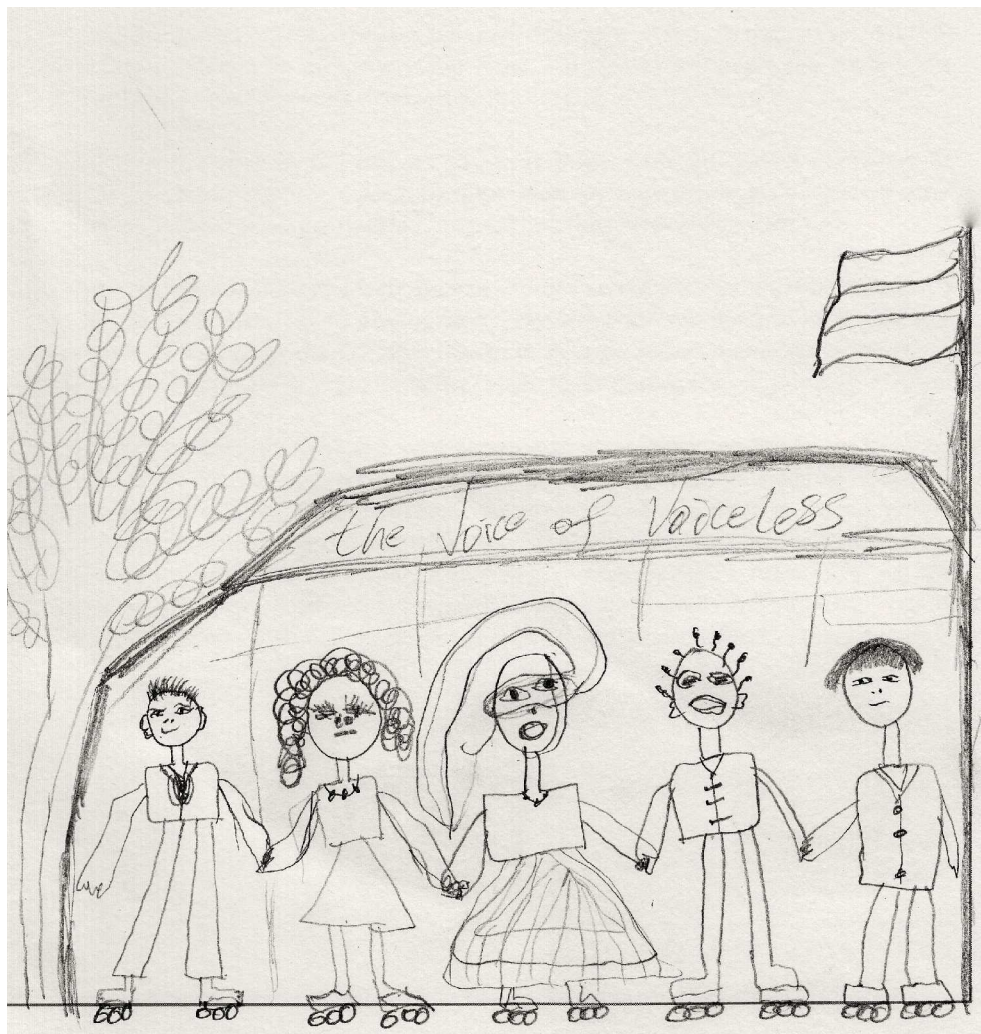

## **Arthur Marriott - The Fourth Rail Bridge**



## **Douglas and Betsie - First Class Dirty Weekend**

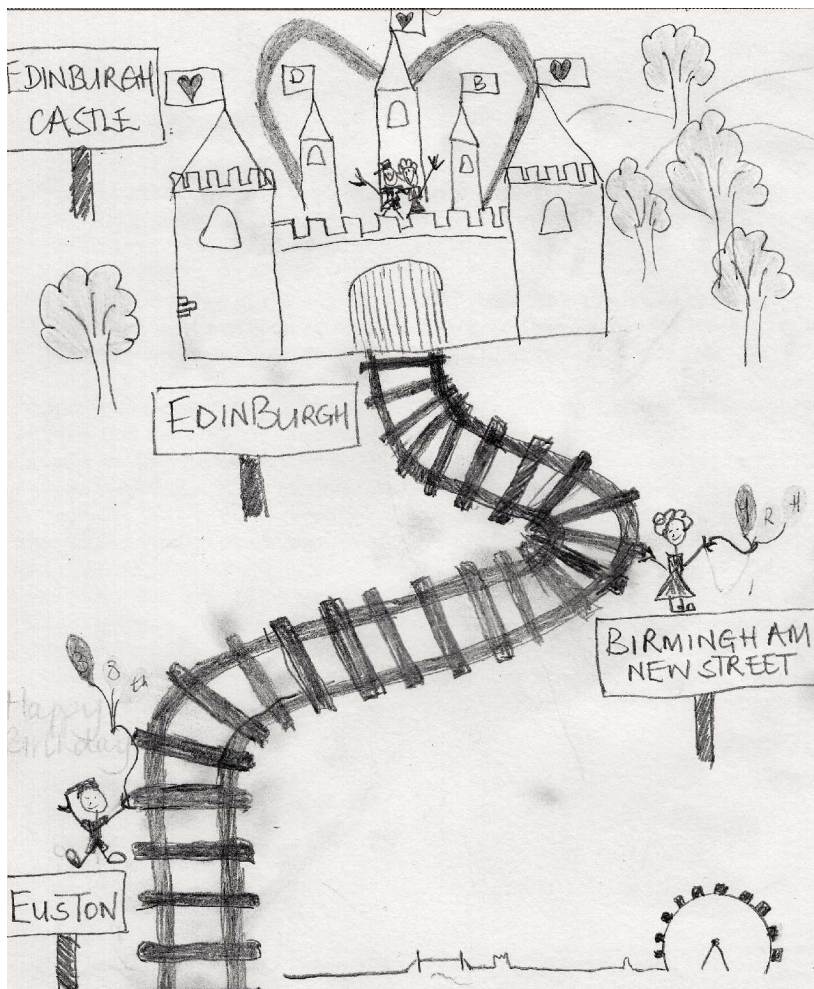

**Sarah, Edward and Ewen Logan**  
**First family holiday with baby Logan**

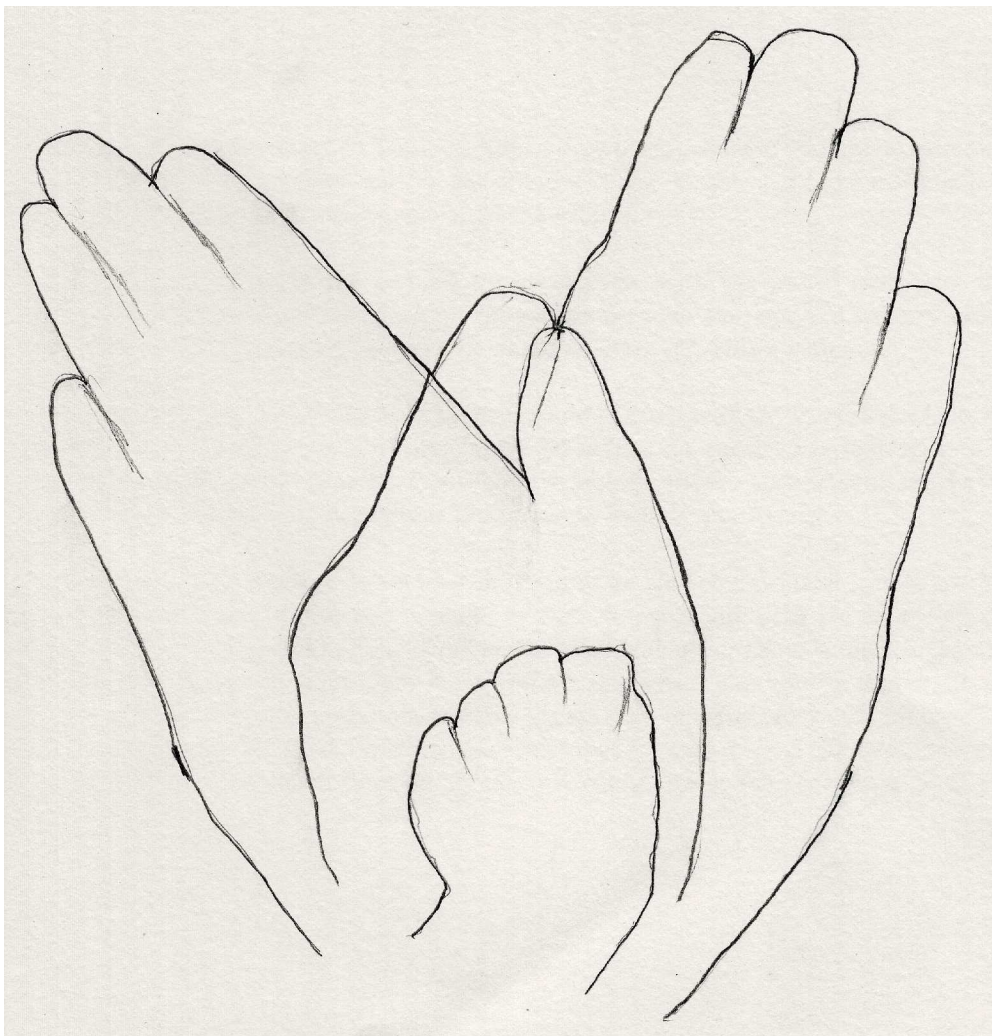

## **Fatema Mansoori – Post Exam Get Away**



## **Levi Taylor – Butterflies and Flowers**

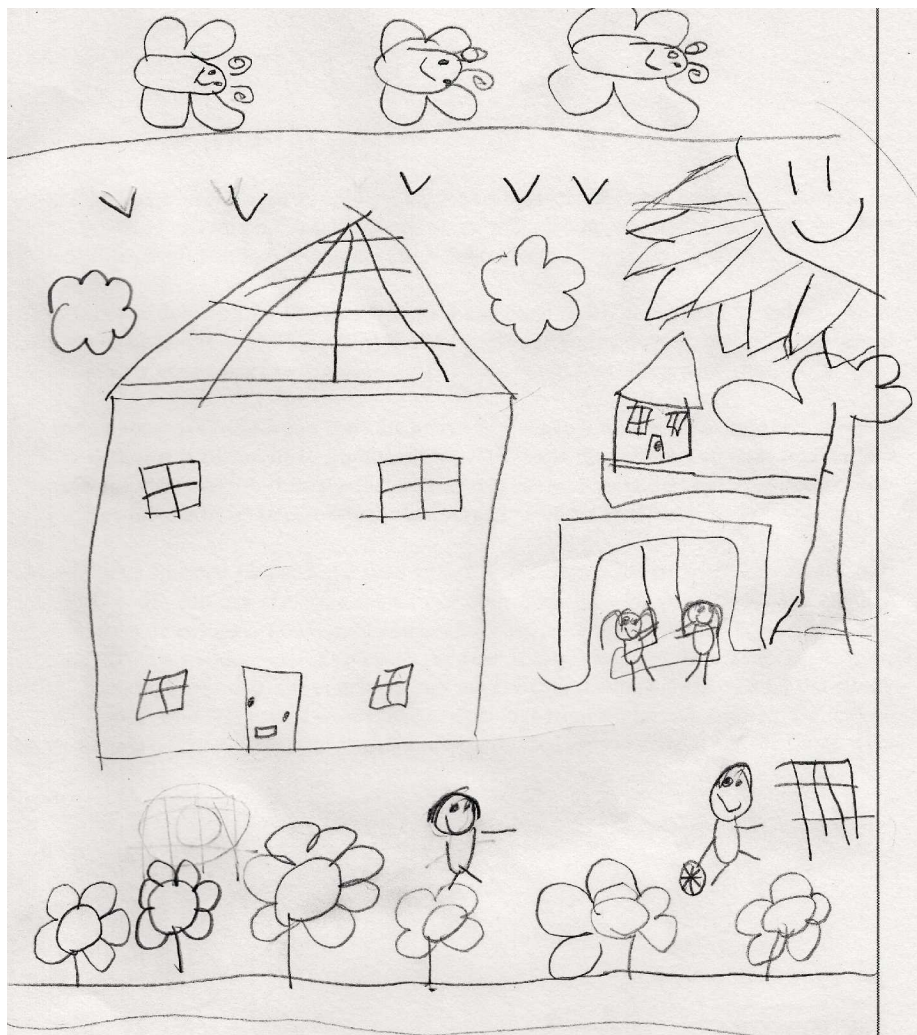

**Miriam -Tunnel View**



## **Chelsea Taylor – Angels Grandad In Heaven**



## **Tommy Clark – My Friday Commute**



## **Georgina Plowder - Terrible Tommy**



## **Philip Adams - Snap Shots Of A Journey**

**'I often draw on trains as there are always lots of models to choose from, although people will keep moving about which makes the drawing more difficult. One also has to be careful to observe surreptitiously as one does not want to be thought to be staring. In this drawing I have tried to give a flavour of the various places and things we passed by on our journey.'**



**Anonymous**



**Quentin Lee - Fuzi Temple in Nanjing**  
**Our Home Town Nanjing is Very Beautiful**

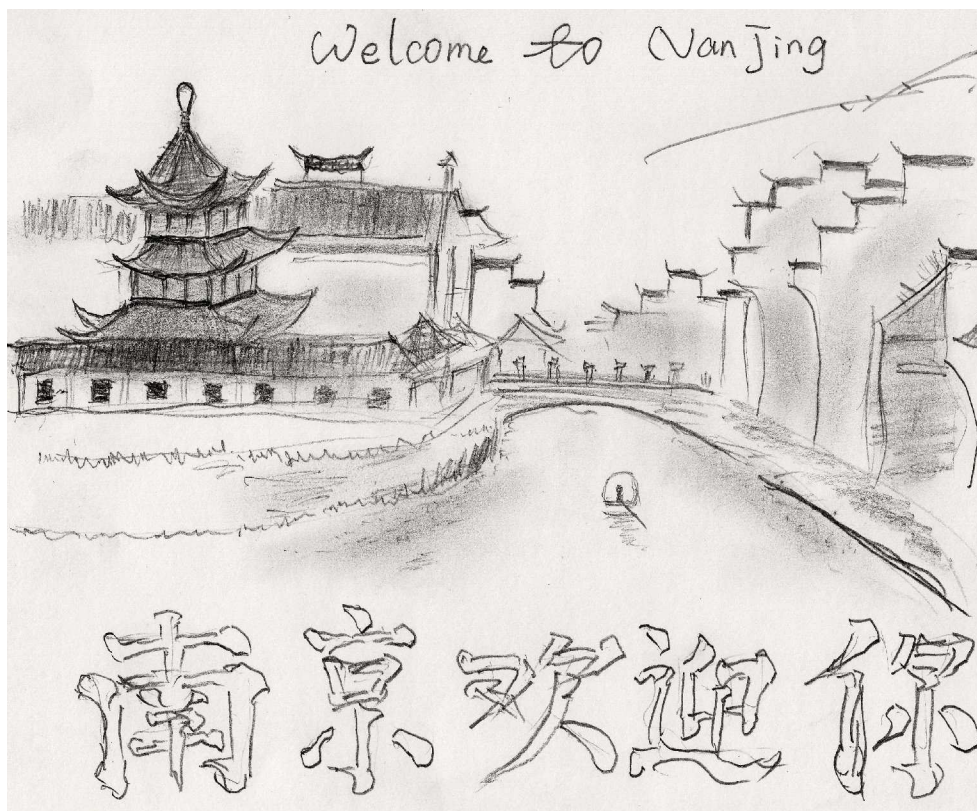

## **John Kirk - Bike Ride In Support Of Breast Cancer**

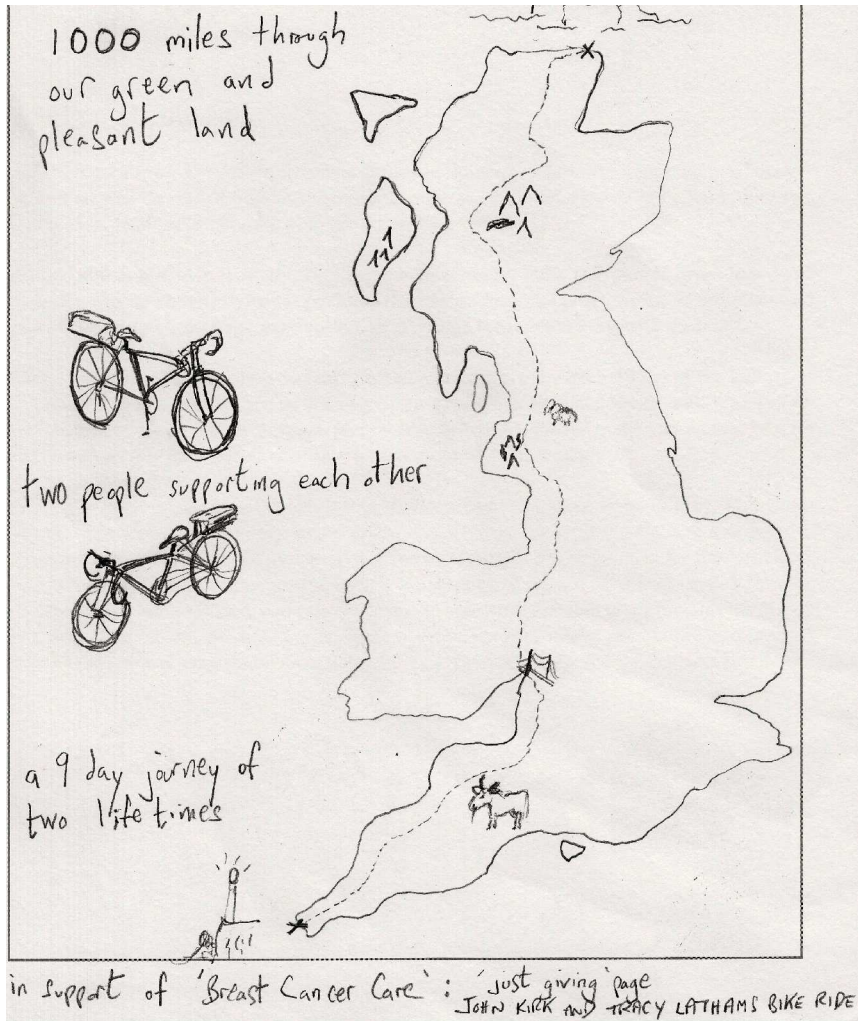

**Dr Ashley Sibery - Wave (Mechanics) To The Sheep**

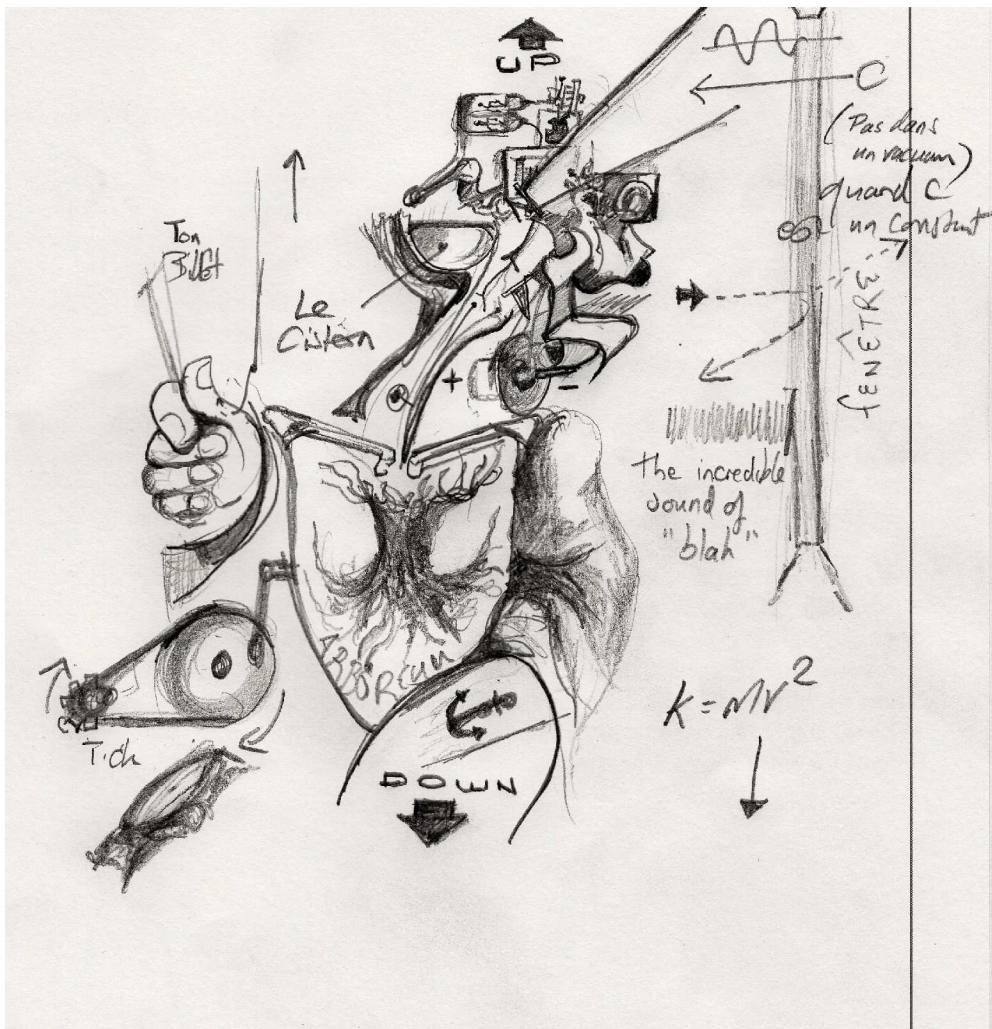

**Bea Mills - Pencil Platform**



## **Anonymous - Wonderful Journey Of Imagination**

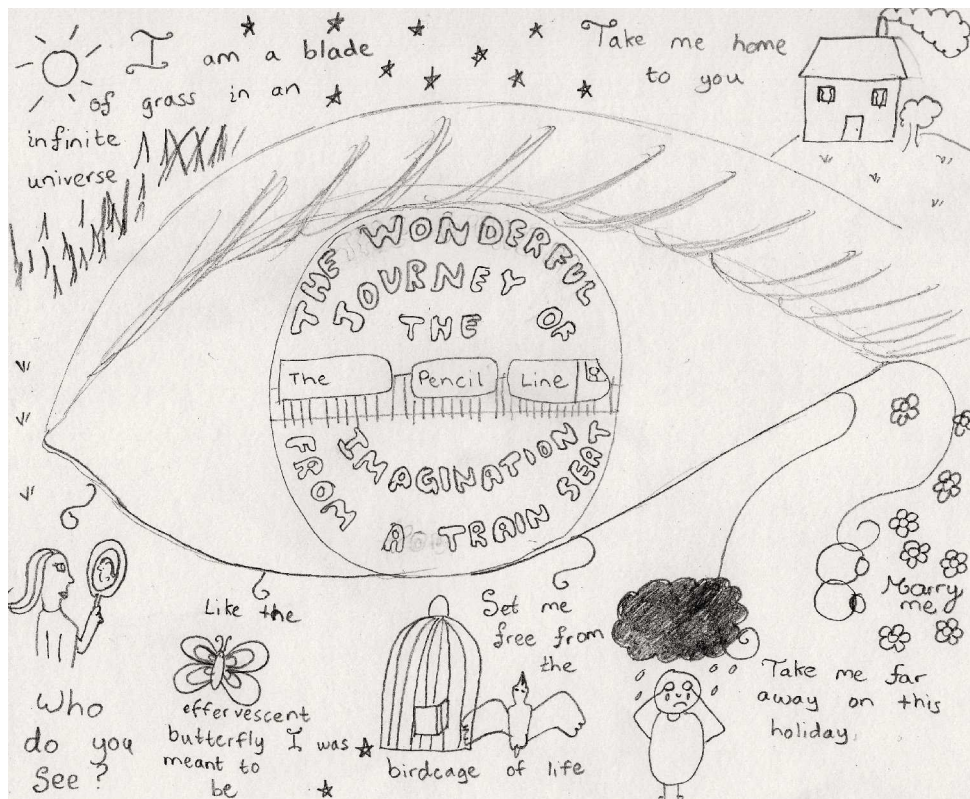



## **Artist Group - Visit To Bradford - On - Avon**

## **Artist Group Visit to Bradford - On - Avon**

**Martin Davis**

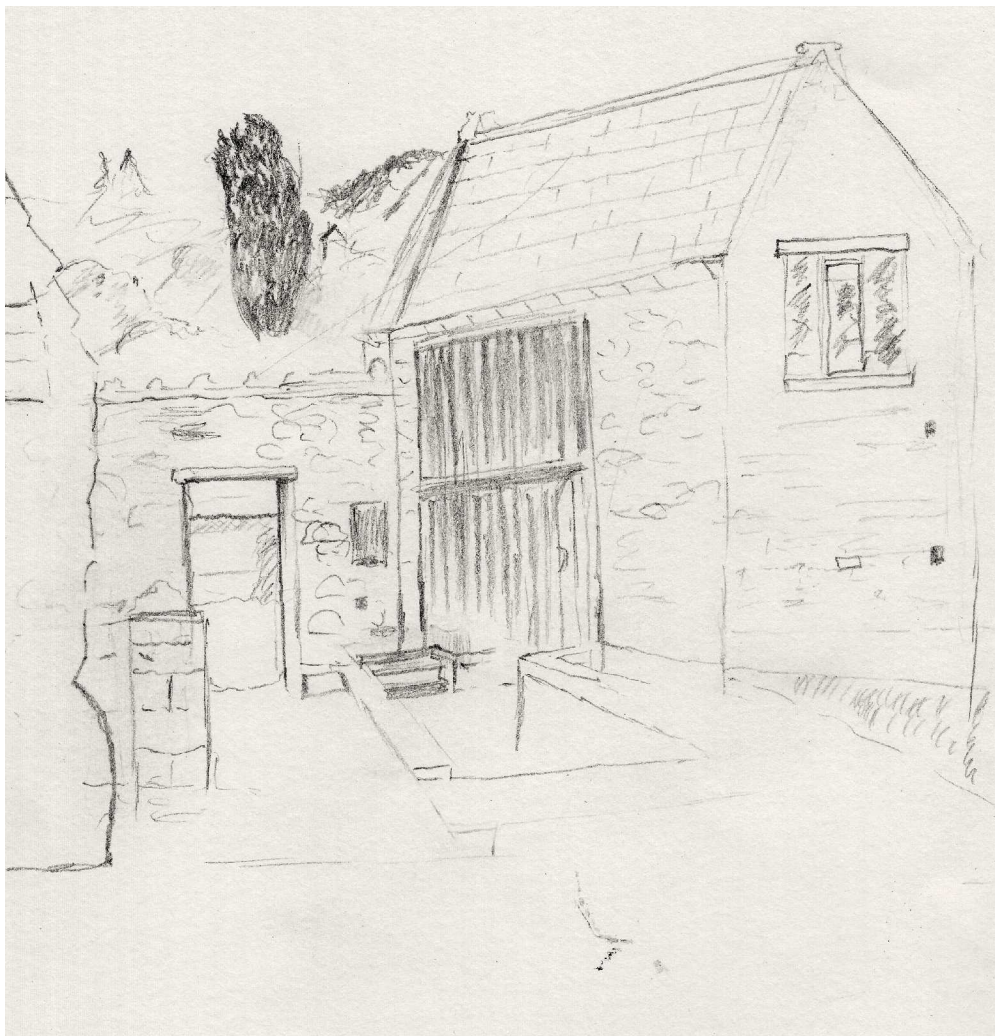

## **Artist Group Visit to Bradford -On - Avon**

**Kris Smith**

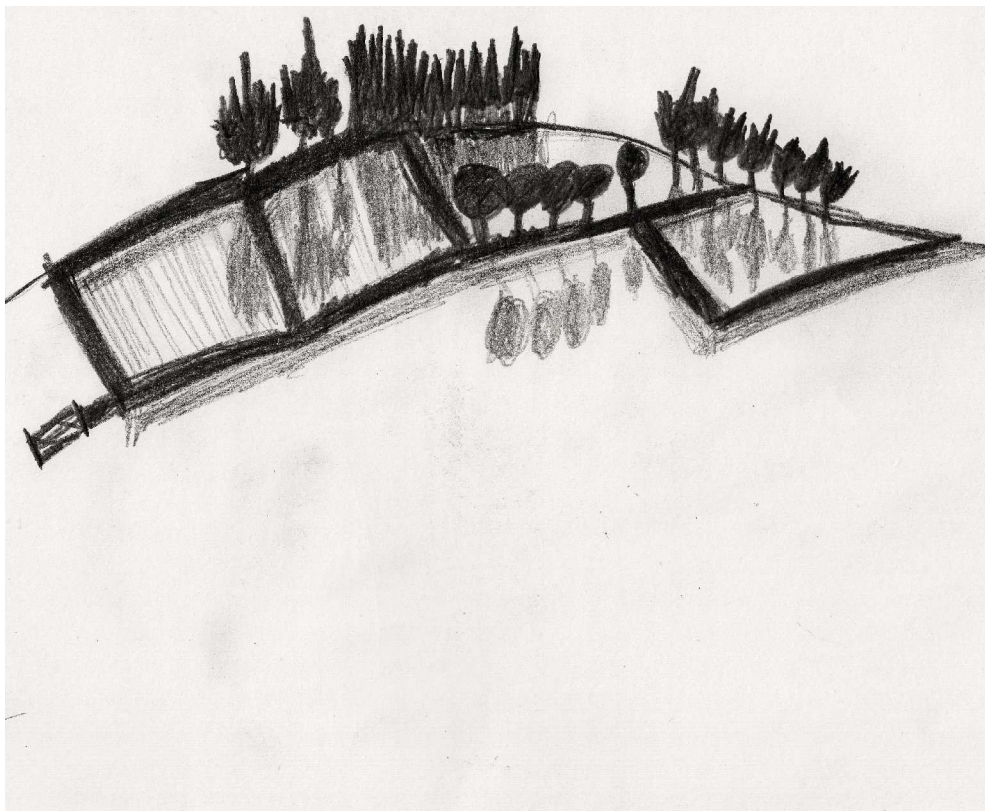

## **Artist Group Visit to Bradford -On -Avon**

**Ashley Valentine Goudou**



## **Artist Group Visit to Bradford -On -Avon**

**Jayne Porter - Pile**

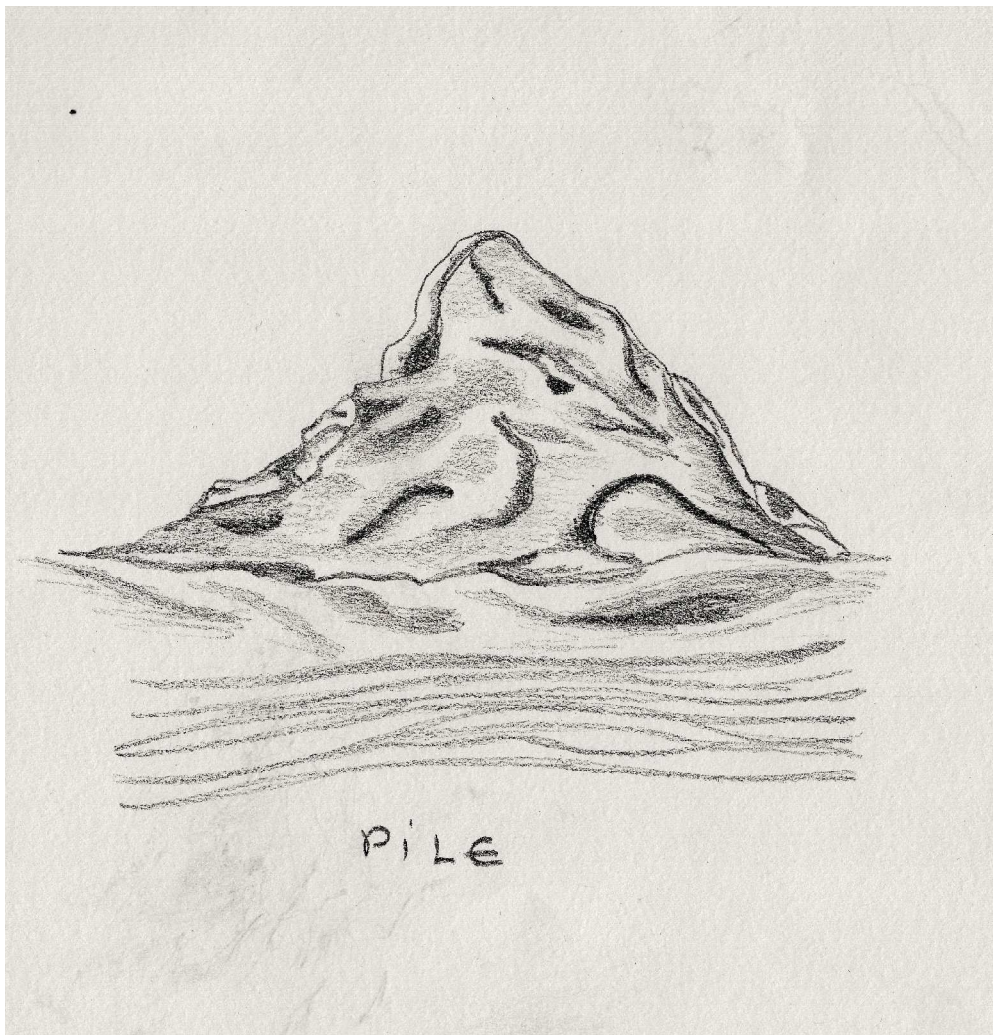

## **Artist Group Visit to Bradford -On - Avon**

**Cythia Booth - Deputy Dog**



## **Morgan Cameron - Project Ability Artist**





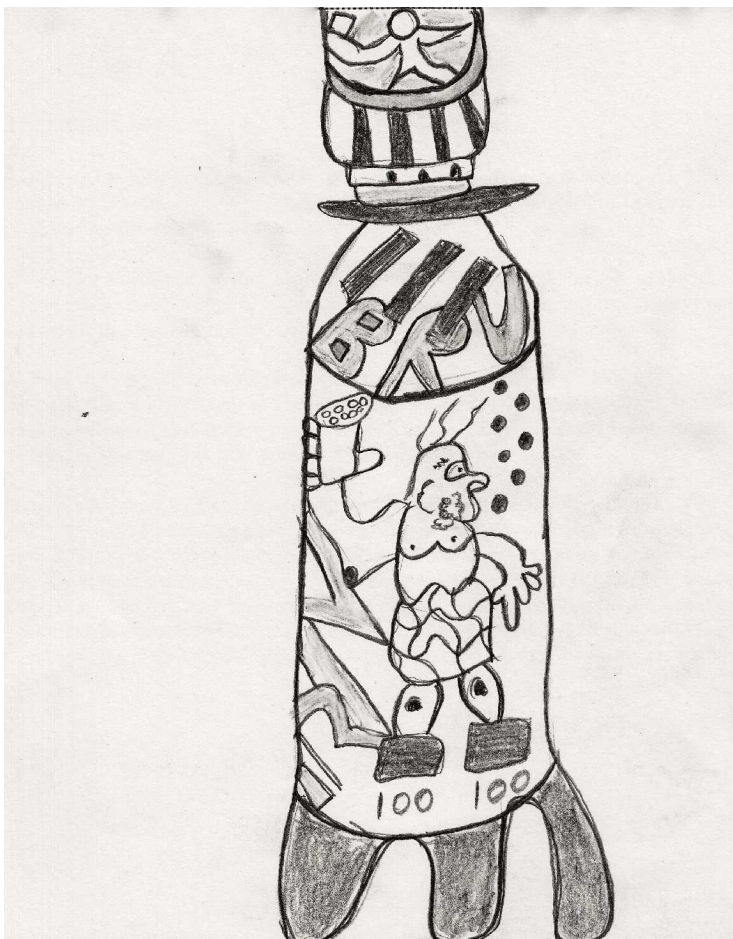

## **Rebecca swindell - Train Tickets**

Along side her pencil drawings Rebecca has also been drawing on train tickets and has drawn on over 435 so far and still drawing!



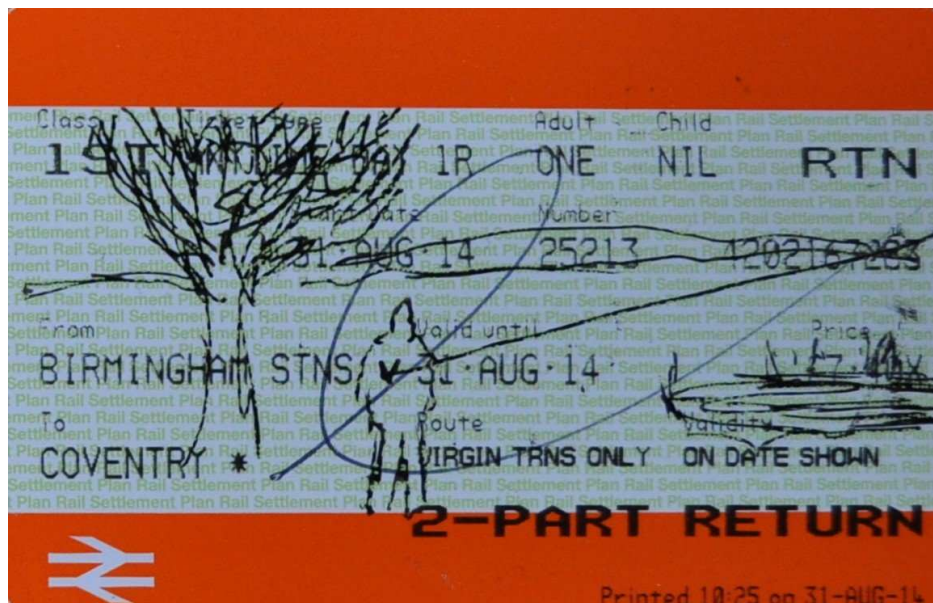



VALID ONLY WITH TICKET 24692

RETAIN FOR INSPECTION

Class	Ticket type	Date of issue	Price
STD	SEAT	02 SEP 14	£0.00X
From	Passenger's Name	Number	
LONDON EASTON *	ONE	2469	5035189225
To	07.30 HOURS ON 02 SEP 14		
LANCASTER *			
Coach	Seats		
B	62		



MANDATORY RESERVATION COUPON 1 OF 1

RK840393

T-D CTR LON/LN34-1750

MISS N GUZHALOVSKAYA

Printed 06.58 on 02-SEP-14

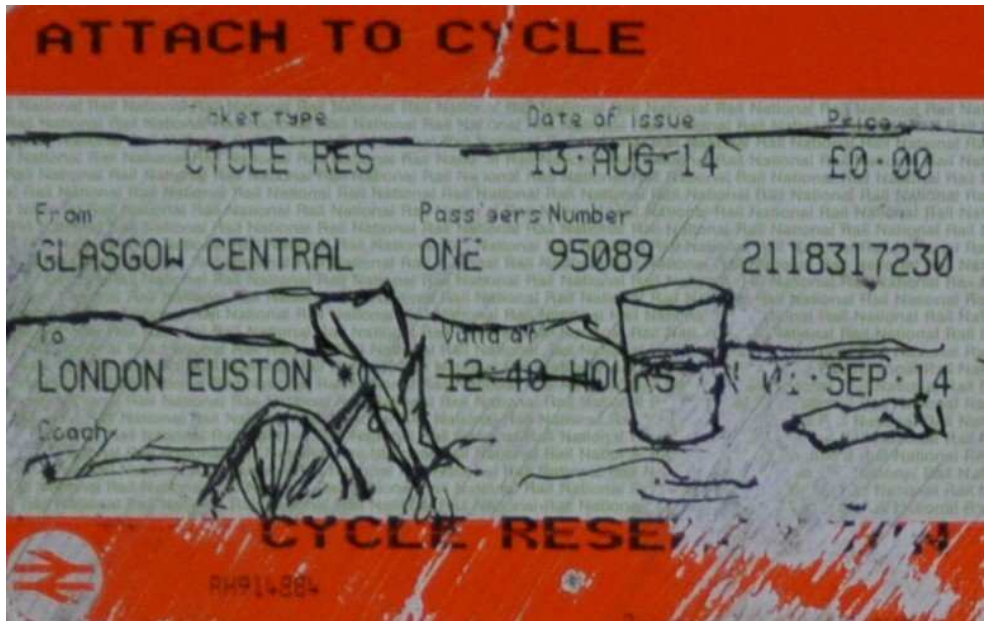



## **Rebecca Swindell**

### **OUT Birmingham To Preston**

### **RETURN Preston To Birmingham**

During the project Rebecca made over 92 drawings, some of these were printed on paper over 5 meters long, detailing the journeys landmarks and people in order from the journeys start to the journeys end.

## The Pencil Line



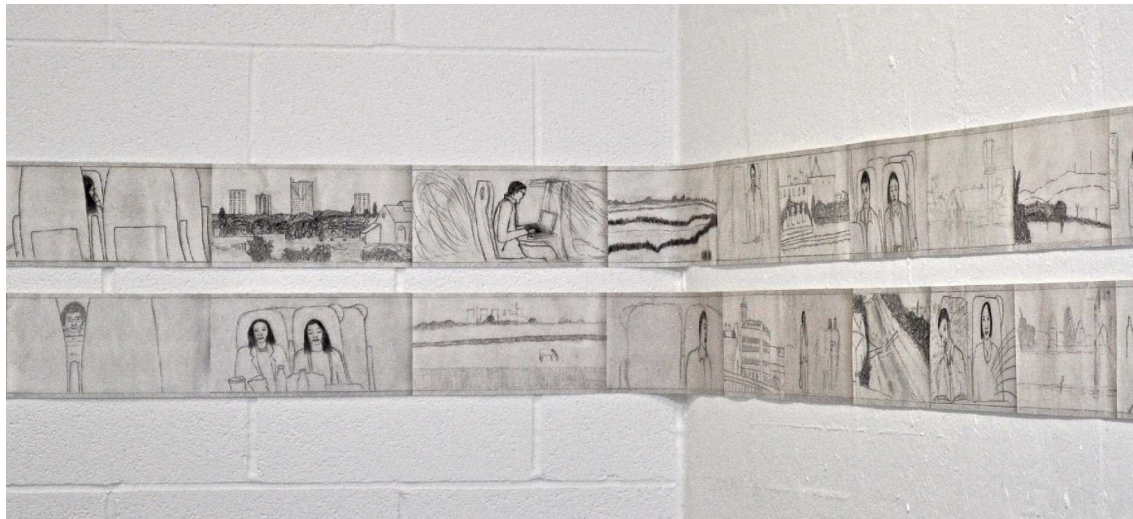







LOTTERY FUNDED



Supported using public funding by

**ARTS COUNCIL  
ENGLAND**